

**BARBECUES : 4 SERIES DH
CLASSIC LS PLUS - LS PLUS D**

DUAL HEAT



4 SERIES CLASSIC DH LS



4 SERIES CLASSIC DH LS PLUS D

**BARBECUES : 4 SERIES DH
CLASSIC LS PLUS - LS PLUS D**

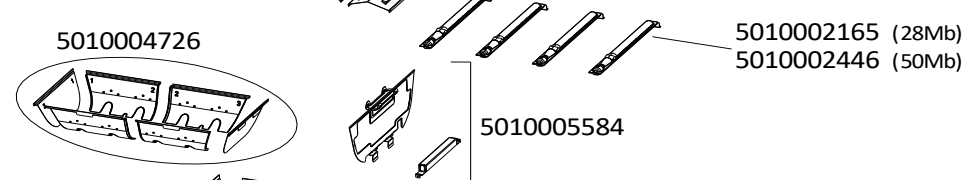
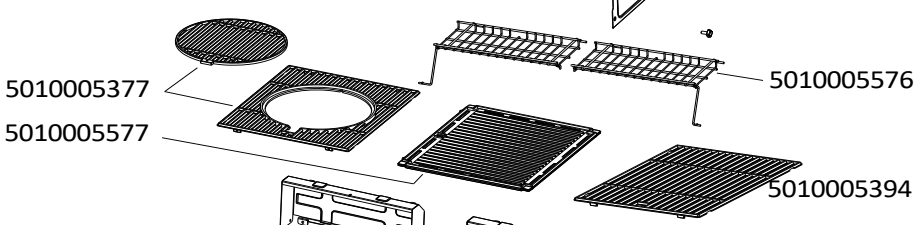
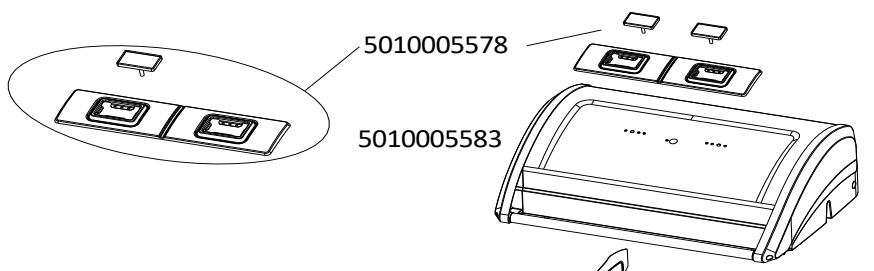

5010002187 (Exp.)
5010002445 (Fr)
5010003284 (Ch)

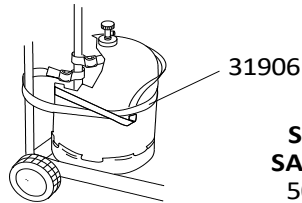
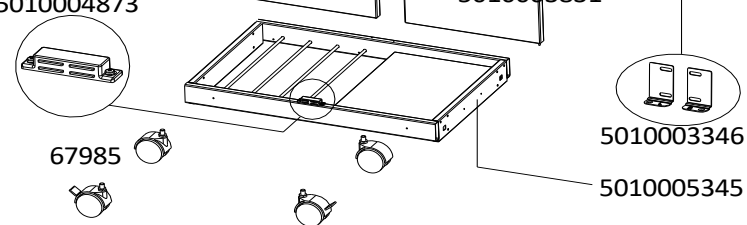
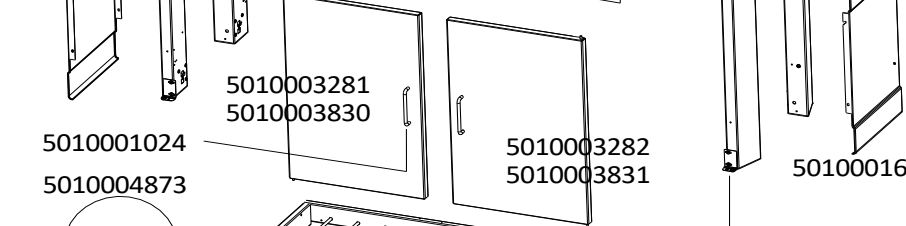
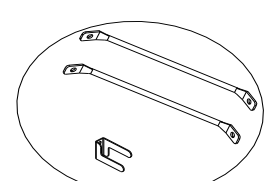
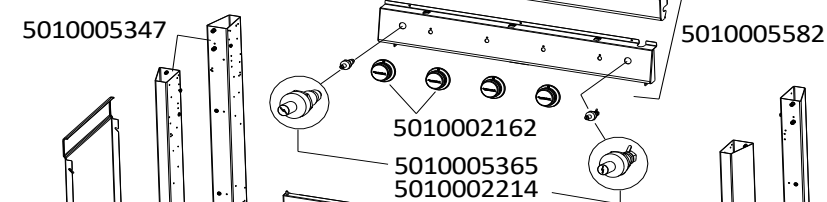
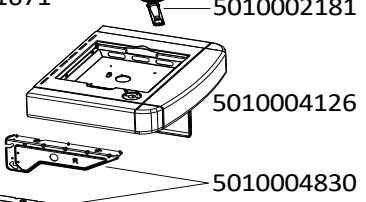
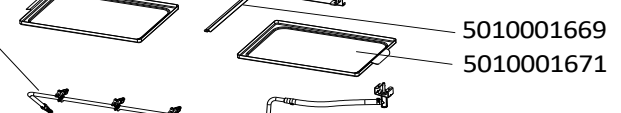
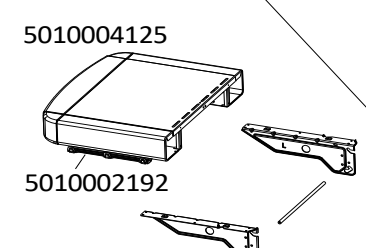
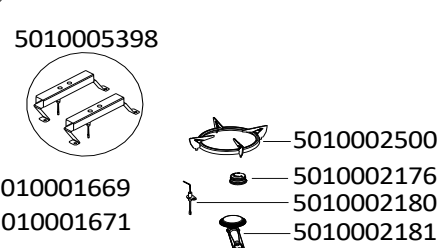
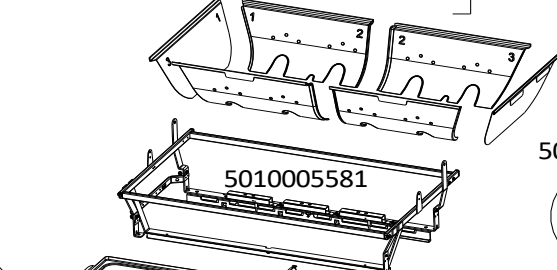

BARBECUES : 4 SERIES DH CLASSIC LS PLUS - LS PLUS D

SPARE PARTS REF.	EN DESCRIPTIONS	FR DESCRIPTIONS
31906	CYLINDER STRAP	SANGLE BOUTEILLE
67985	SET OF WHEELS (x2)	ENSEMBLE ROUES (x2)
5010001024	HANDLE / USTENSIL HOLDER	POIGNEE / PORTE USTENSILE
5010001598	STEEL HEAT DIFFUSER (x1)	DIFFUSEUR DE CHALEUR ACIER (x1)
5010001648	LEFT OR RIGHT SIDE PANEL (DARK GREY)	PANNEAU LATERAL GAUCHE OU DROITE (GRIS FONCE)
5010001669	GREASE DRAWER TENT	TENTE TIROIR RAMASSE GRAISSE
5010001671	GREASE PLATE (x1)	PLATEAU RAMASSE GRAISSE (x1)
5010002162	KNOB (x2)	VOLANT (x2)
5010002165	STAINLESS STEEL BURNER 28Mb	BRULEUR INOX 28Mb
5010002176	KIT OF 2 KNOBS FOR SIDE STOVE	KIT DE 2 VOLANTS POUR RECHAUD LATERAL
5010002180	ELECTRODE FOR SIDE STOVE	ELECTRODE RECHAUD LATERAL
5010002181	SIDE STOVE BURNER	BRULEUR POUR RECHAUD LATERAL
5010002187	STOVE GAS PIPE 28Mb (Export)	TUBULURE RECHAUD 28Mb (Export)
5010002192	USTENSIL HOOK	PORTE USTENSILES
5010002214	PIEZO 1 OUTLET	PIEZO SIMPLE
5010002282	REINFORCEMENT WIRE SIDE SHELF	FIL RENFORT ETAGERE
5010002445	STOVE PIPE 28Mb 1/2" (Fr)	TUBULURE RECHAUD 28Mb 1/2" (Fr)
5010002446	STAINLESS STEEL BURNER 50Mb	BRULEUR INOX 50Mb
5010002500	SIDE STOVE PAN SUPPORT	SUPPORT DE CASSEROLE RECHAUD LATERAL
5010003148	SCREW BAG	SACHET DE VIS
5010003281	LEFT DOOR WITHOUT HANDLE (DARK GREY)	PORTE GAUCHE SANS POIGNEE (GRIS FONCE)
5010003282	RIGHT DOOR WITHOUT HANDLE (DARK GREY)	PORTE DROITE SANS POIGNEE (GRIS FONCE)
5010003284	STOVE PIPE 28Mb 1/4" (Ch)	TUBULURE RECHAUD 28Mb 1/4" (Ch)
5010003346	AXLE SUPPORTS FOR DOORS (MOD. 2016 AND AFTER) + 2 CHASSIS SQUARES	SUPPORTS AXE PORTES (MOD. A PARTIR DE 2016) + 2 EQUERRES CHASSIS
5010003830	LEFT DOOR WITHOUT HANDLE (MOD. 2016 AND AFTER) - (LIGHT GREY)	PORTE GAUCHE SANS POIGNEE (MOD. A PARTIR DE 2016) - (GRIS CLAIR)
5010003831	RIGHT DOOR WITHOUT HANDLE (MOD. 2016 AND AFTER) - (LIGHT GREY)	PORTE DROITE SANS POIGNEE (MOD. A PARTIR DE 2016) - (GRIS CLAIR)
5010004125	LEFT OR RIGHT SIDE TABLE WITH USTENSIL HOOK - TEXTURED DARK GREY	ETAGERE GAUCHE OU DROITE AVEC PORTE USTENSILES - TEXTURE GRIS FONCE
5010004126	SIDE BURNER SHELF W/LID - TEXTURED DARK GREY	ETAGERE RECHAUD LATERAL AVEC COUVERCLE - TEXTURE GRIS FONCE
5010004726	KIT OF REMOVABLE PARTS (FIREBOX)	KIT DE PARTIES AMOVIBLES (CUVE)
5010004830	SIDE SHELF SUPPORTS (RIGHT AND LEFT) - TEXTURED DARK GREY	SUPPORTS ETAGERE (DROITE ET GAUCHE) - TEXTURE GRIS FONCE
5010004873	MAGNETS (X2)	AIMANTS (X2)
5010004875	ACCESSORY BAG	SACHET D'ACCESSOIRES
5010004931	LID PADS (x2) + BASE CUSHIONS (x2) + LEG GROMMETS (x4)	PATINS COUVERCLE (x2) + BOUCHONS CUVE (x2) + RONDELLES PIED (x4)
5010005345	CHASSIS (MOD. 2019 AND AFTER)	CHASSIS (MOD. A PARTIR DE 2019)
5010005347	KIT LEGS (X4) (MOD. 2019 AND AFTER)	KIT PIEDS (X4) (MOD. A PARTIR DE 2019)
5010005365	PIEZO DOUBLE	PIEZO DOUBLE
5010005377	ENAMELLED CAST IRON COOKING GRID (FRAME + CIRCLE) - MATTE (MOD. 2019 AND AFTER)	GRILLE DE CUISSON FONTE EMAILLEE (CADRE + CERCLE) - MATE (MOD. A PARTIR DE 2019)
5010005394	ENAMELLED CAST IRON COOKING GRID - MATTE (MOD. 2019 AND AFTER)	GRILLE DE CUISSON FONTE EMAILLEE - MATE (MOD. A PARTIR DE 2019)
5010005398	KIT OF ELECTRODES + HOUSINGS	KIT ELECTRODES + SUPPORTS
5010005574	LEFT AND RIGHT WINDSHIELDS	PAREVENTS GAUCHE ET DROITE
5010005576	LEFT AND RIGHT WARMING GRIDS	GRILLES DE MIJOTAGE GAUCHE ET DROITE
5010005577	ENAMELLED CAST IRON COOKING GRIDDLE - MATTE	PLAQUE DE CUISSON FONTE EMAILLEE - MATE
5010005578	THERMOMETER WITH BEZEL	THERMOMETRE AVEC BAGUE
5010005581	BASE FRAME	CADRE SUPPORT DE CUVE

**BARBECUES : 4 SERIES DH
CLASSIC LS PLUS - LS PLUS D**

SPARE PARTS REF.	EN DESCRIPTIONS	FR DESCRIPTIONS
5010005582	TOP + BOTTOM CONTROL PANELS - LIGHT GREY	CONSOLES HAUT + BAS - GRIS CLAIR
5010005583	LID W/O THERMOMETER AND W/O DIVIDER - PAINTED BLACK	COUVERCLE SANS THERMOMETRE ET SANS PAROI SEPARATRICE - PEINT NOIR
5010005584	FIREBOX DIVIDER WITH BOTTOM SUPPORT (+ SCREWS)	PAROI SEPARATRICE POUR CUVE AVEC SUPPORT INFERIEUR (+ VIS)